



Fig. 40—Removing Ventilator Assembly—867

4. Remove screws holding lower guide rail to door panel.
5. Remove regulator assembly from large access opening as shown in Figure 48.

Installation

Regulator may be installed by following removal

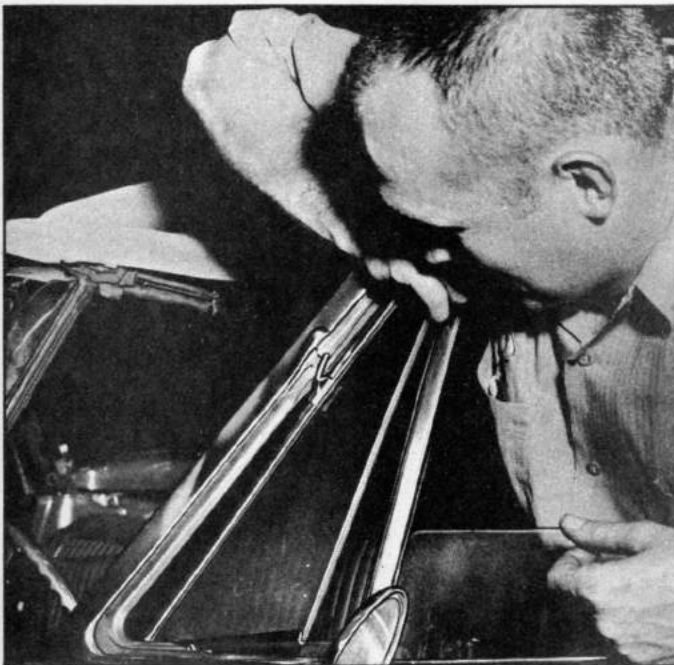

Fig. 41—Removing Vent Window Assembly—867



Fig. 42—Removing Sash Retaining Screws

procedure in reverse order. Always lubricate all guide rails and rollers when regulator is disassembled. Test regulator thoroughly before installing door trim panel. Adjust window as outlined in this section.

WINDOW REGULATOR—POWER

In cases where window will not operate, check elec-



Fig. 43—Removing Door Window

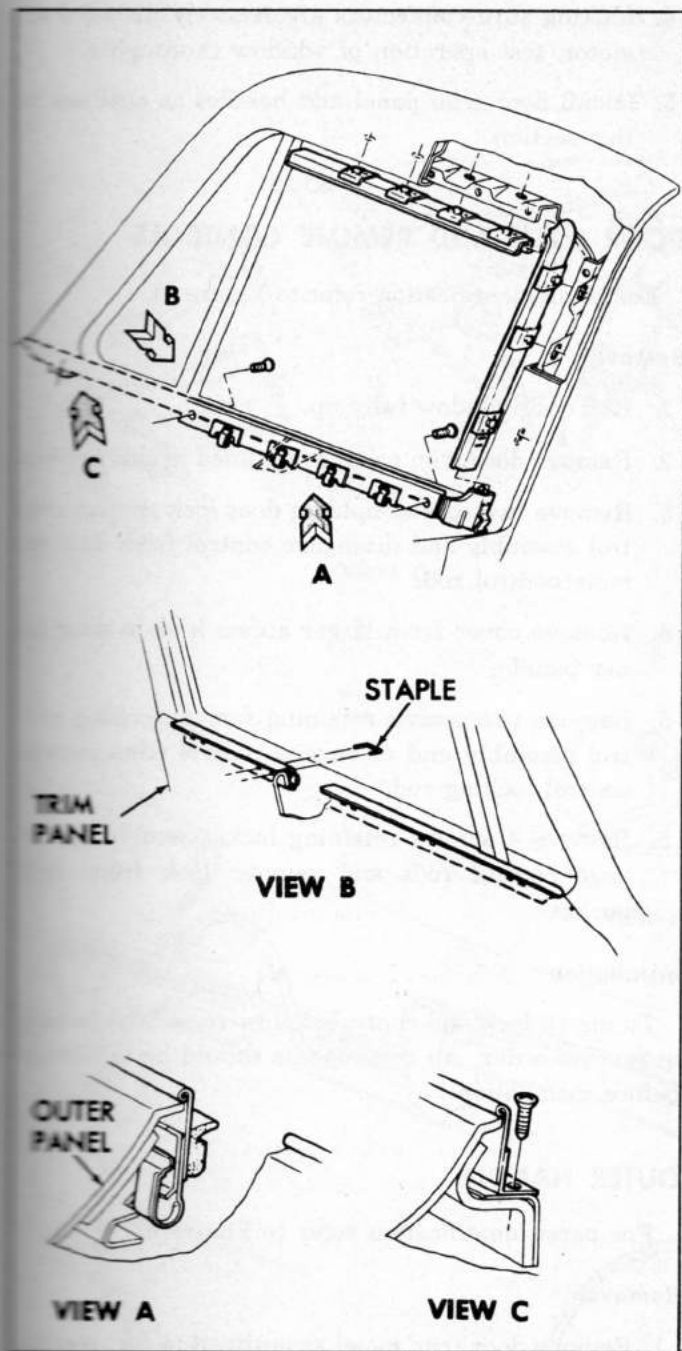

Fig. 44—Window Run and Seal Assembly

Electrical connections first. Figure 49 illustrates location of junctions, switches and circuit breaker.

Removal

Perform operations 1 thru 5 under *Window Regulator—Manual Removal*. Note, however, that electrical connectors must be removed from motor before performing any operation on regulator. Figure 49 illustrates installation of regulator on door and regulator wiring.



Fig. 45—Installing Outer Seal

Disassembly

NOTE: Do not attempt to remove motor from regulator until the following operations are performed. **THIS IS A SAFETY ITEM;** arm is spring-loaded and may cause injury if not locked in position when motor is removed.

Refer to Figure 50.

1. Place regulator assembly in vise.
2. Using jumper leads to 12 volt power supply, operate motor until semi-circular hole in sector gear

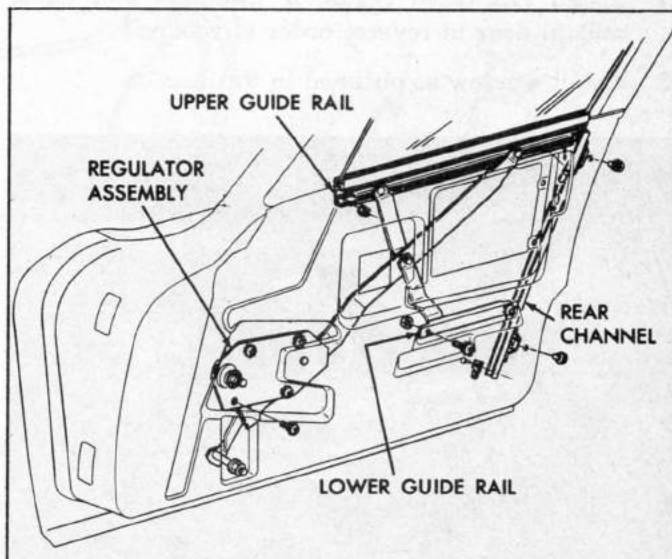

Fig. 46—Rear Channel and Regulator Assembly



Fig. 47—Removing Rear Channel

centers over one of two weld nuts on mounting plate.

3. Screw a $\frac{1}{4}$ "-20x1" bolt into weld nut so that end passes through hole in sector gear. It may be necessary to enlarge hole in gear slightly with file or drill. Install nut on bolt to lock arm in position.

Installation

1. Be sure lock bolt has been removed if regulator has been disassembled.
2. Install lubricated regulator assembly and guide rails in door in reverse order of removal.
3. Install window as outlined in this section.



Fig. 48—Removing Regulator Assembly

4. Making sure connectors are securely installed on motor, test operation of window thoroughly.
5. Install door trim panel and handles as outlined in this section.

DOOR LOCK AND REMOTE CONTROLS

For parts identification refer to Figure 51.

Removal

1. Roll door window fully up.
2. Remove door trim panel as outlined in this section.
3. Remove two screws holding door lock remote control assembly and disengage control from lock remote control rod.
4. Remove cover from larger access hole in door inner panel.
5. Remove two screws retaining remote locking control assembly and disengage control from remote control locking rod.
6. Remove 4 screws retaining lock assembly, disengage control rods and remove lock from door pocket.

Installation

To install lock and controls follow removal assembly in reverse order. All components should be lubricated before installation.

OUTER HANDLE

For parts identification refer to Figure 52.

Removal

1. Remove door trim panel as outlined in this section. Remove larger access hole cover.
2. Roll door window fully up.
3. Working through access hole, remove 2 door handle retaining screws.
4. Remove handle from door outer surface. Retrieve reinforcement from inside door pocket. Discard old gaskets.

Installation

1. Install new gaskets and position door handle on door outer panel.

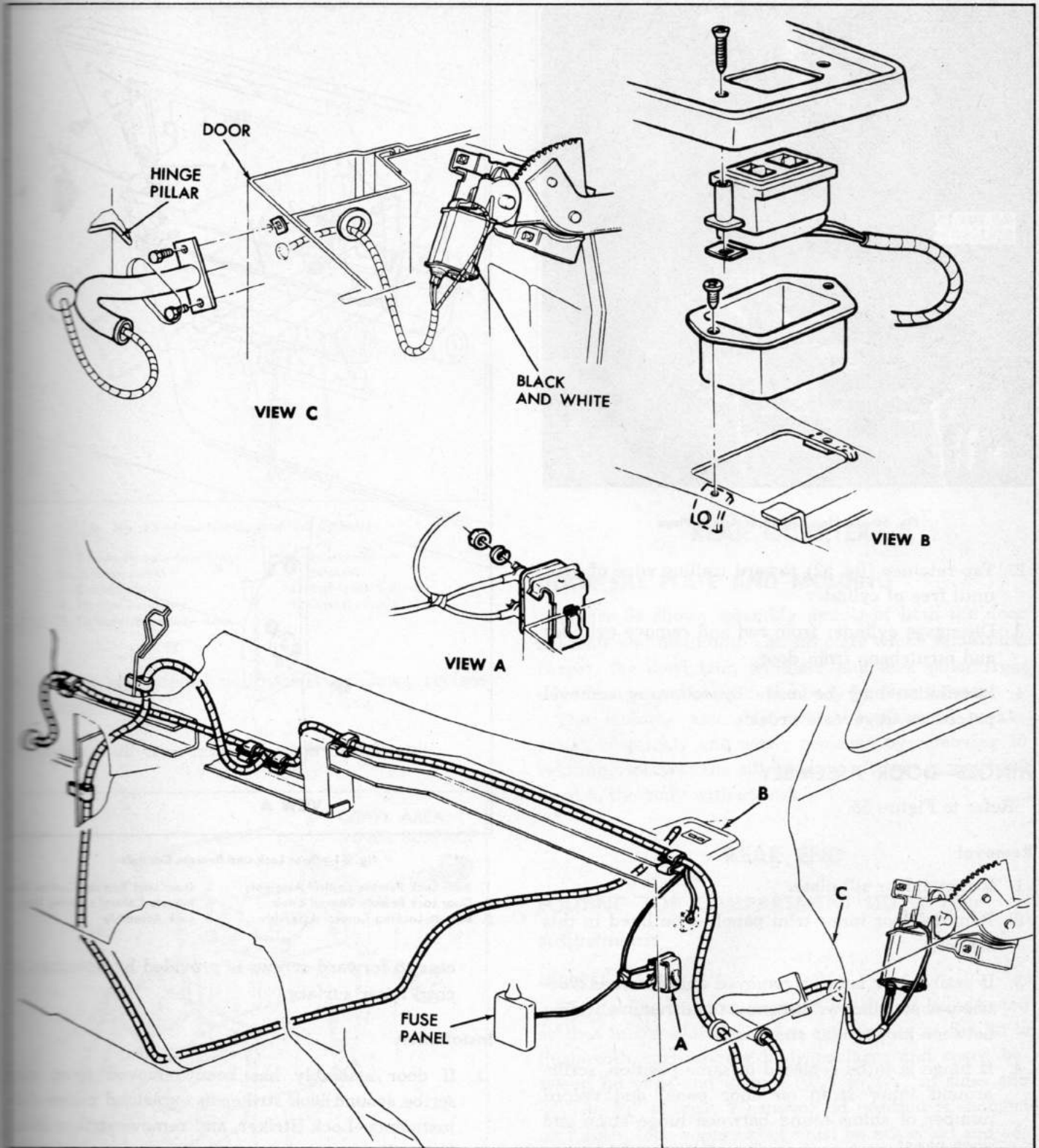

Fig. 49—Power Window Regulator

2. Position reinforcement on door inner panel and install handle retaining screws.
3. Carefully check operation of door lock.
4. Install door trim panel as outlined in this section.

LOCK CYLINDER

Replacement

1. Perform Operations 1 and 2 under Outer Handle—Removal.

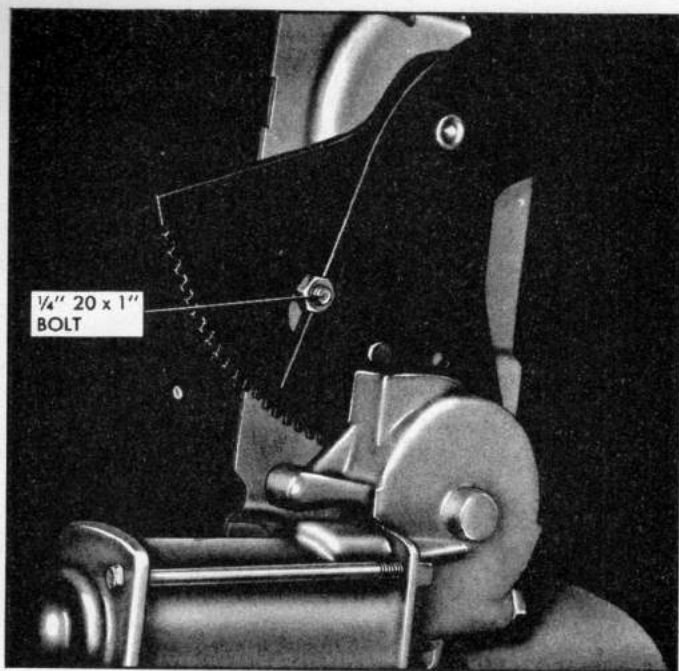

Fig. 50—Locking Regulator Arm In Place

2. Tap retainer (fig. 52) toward trailing edge of door until free of cylinder.
3. Disengage cylinder from rod and remove cylinder and escutcheon from door.
4. Installation may be made by following removal procedure in reverse order.

HINGES—DOOR ASSEMBLY

Refer to Figure 53.

Removal

1. Remove door sill plate.
2. Remove door inner trim panel as outlined in this section.
3. If entire door is to be removed and door has electric power window, disconnect and remove wiring between hinge pillar and door.
4. If hinge is to be replaced in same position, scribe around inner strap on door panel and record number of shims found between hinge strap and door panel.
5. Remove bolts retaining hinge to door; do not allow door to hang unsupported on one hinge.
6. Remove cowl panel inner trim as explained under *Front End—Cowl Area and Console Trim*.
7. Remove cap screws retaining hinge to body. Ac-

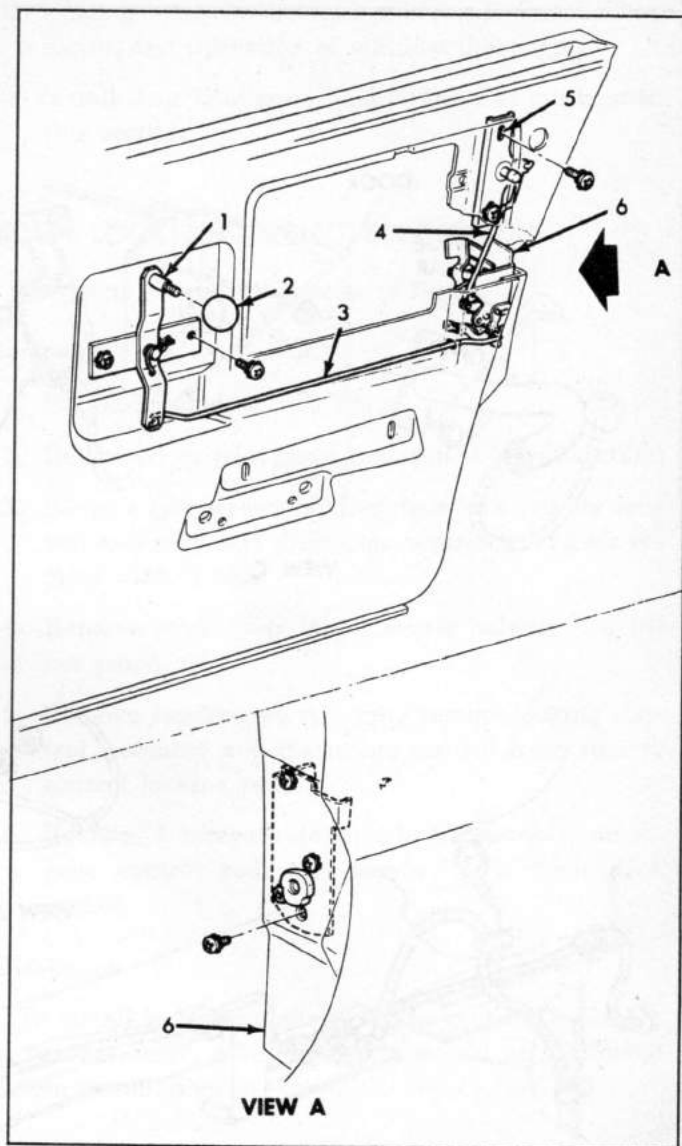

Fig. 51—Door Lock and Remote Controls

- | | |
|--------------------------------------|---------------------------------|
| 1. Door Lock Remote Control Assembly | 3. Door Lock Remote Control Rod |
| 2. Door Lock Remote Control Knob | 4. Remote Control Locking Rod |
| 5. Remote Locking Control Assembly | 6. Lock Assembly |

cess to forward screws is provided by openings in cowl inner surface.

Installation

1. If door assembly has been removed from car, scribe around lock striker as explained under *Adjustments—Lock Striker*, and remove striker from lock pillar.
2. Install hinges, replacing same number of shims removed and aligning door hinge straps with marks scribed upon disassembly.
3. Perform door adjustments as outlined in this section.