

Parking Brake Lever Replacement

Removal Procedure

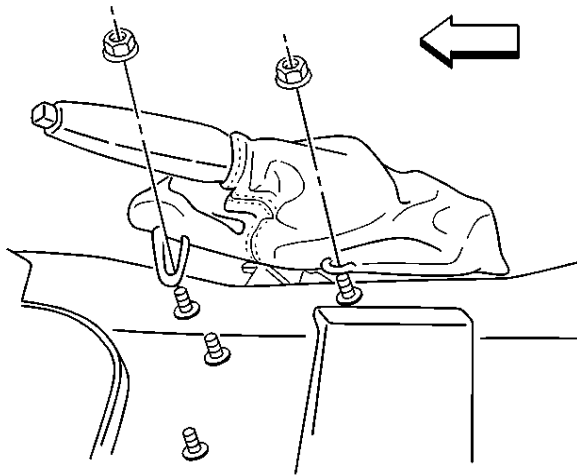

1. Remove the accessory trim plate. Refer to [Console Replacement](#).
2. Remove the passenger seat. Refer to [Driver or Passenger Seat Replacement](#).
3. Lift and disengage the retainer clips on the park brake lever boot.

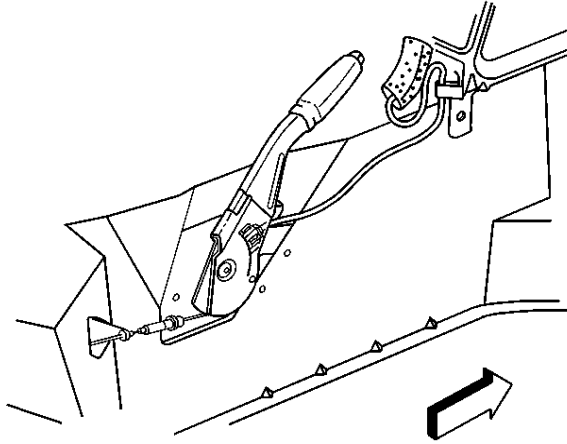

4. Disconnect the parking brake electrical connector.
5. Disable the parking brake automatic adjuster. Refer to [Parking Brake Cable Adjuster Disabling](#).

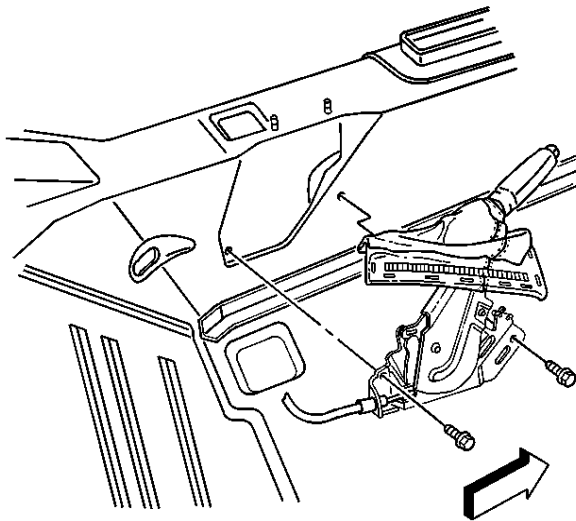

6. Remove the parking brake lever assembly mounting bolts.
7. Reposition the park brake lever.

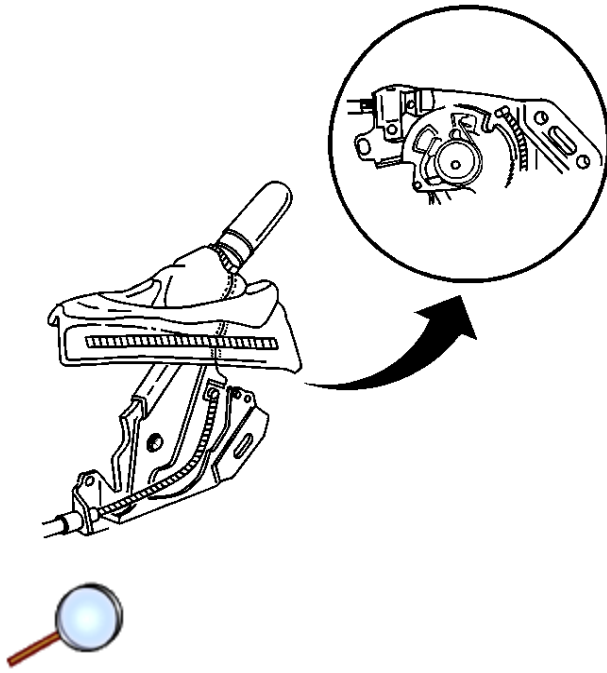

8. Disconnect the front parking brake cable from the drive sector and park brake lever assembly.

Installation Procedure

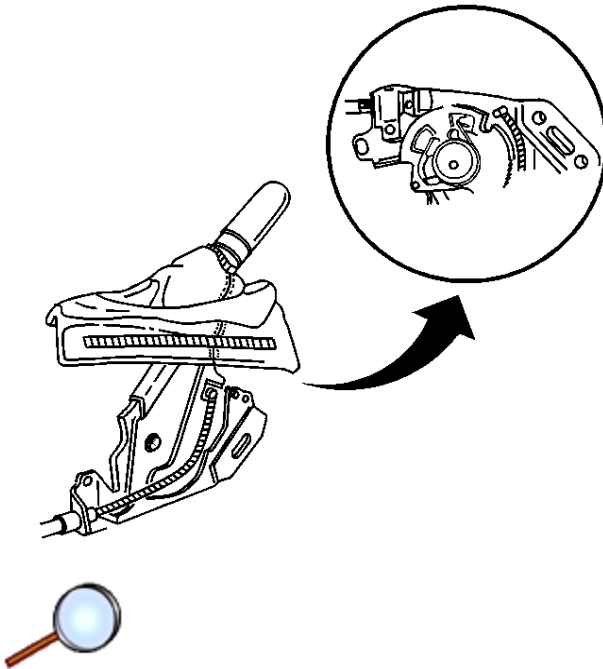

1. Connect the front parking brake cable to the drive sector and park brake lever assembly.

Caution: Refer to [Fastener Caution](#) in the Preface section.

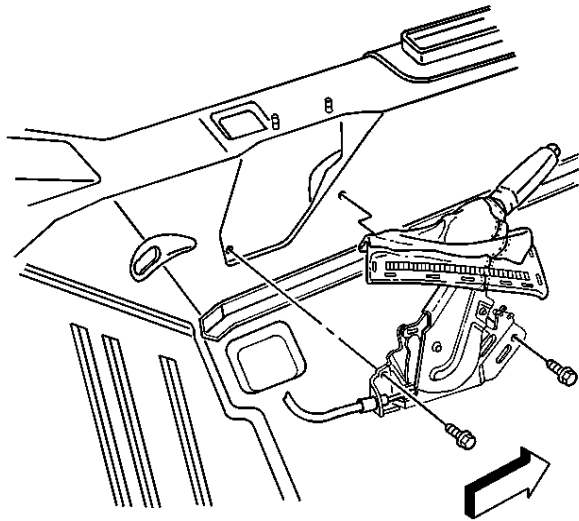

2. Install the parking brake lever assembly mounting bolts.

Tighten

Tighten the parking brake lever assembly mounting bolts to 28 N·m (21 lb ft).

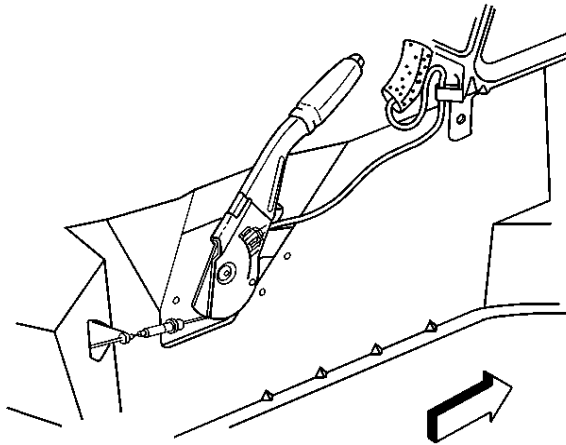

3. Connect the parking brake electrical connector.

4. Enable the parking brake automatic adjuster. Refer to [Parking Brake Cable Adjuster Enabling](#).

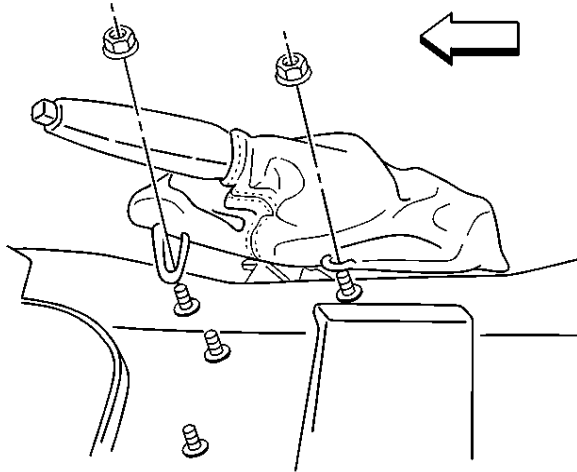

5. Install the parking brake lever boot nuts.

Tighten

Tighten the parking brake lever boot nuts to 10 N·m (89 lb in).

6. Install the passenger seat. Refer to [Driver or Passenger Seat Replacement](#).
7. Install the accessory trim plate. Refer to [Console Replacement](#).

Console Replacement

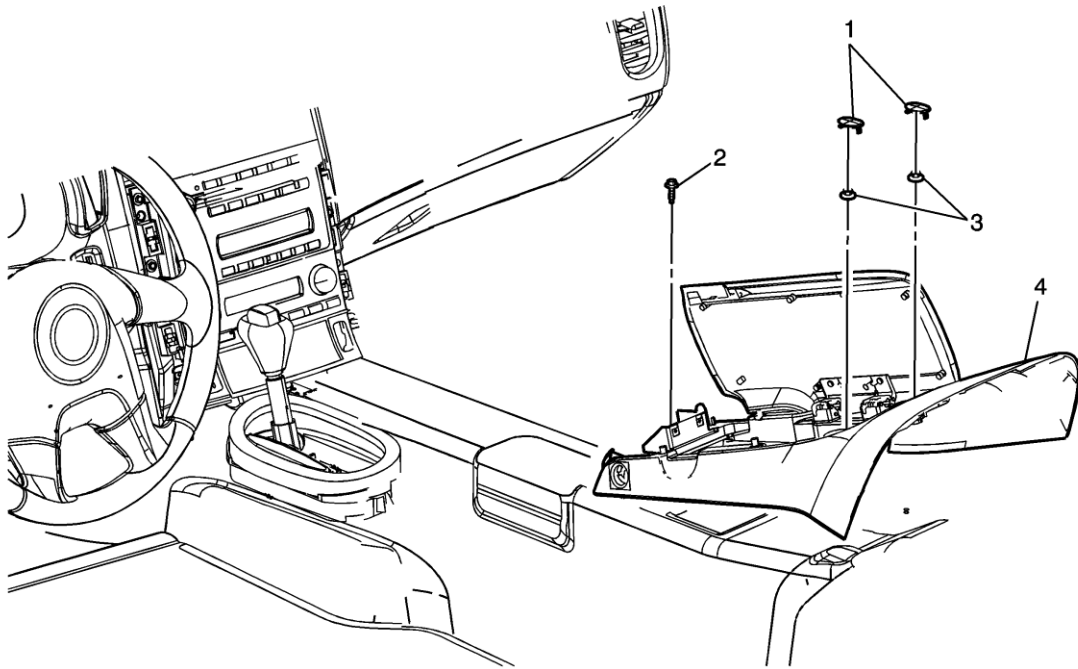

Callout	Component Name
<p>Preliminary Procedures</p> <ol style="list-style-type: none"> 1. Remove the instrument panel accessory trim plate. Refer to Instrument Panel Accessory Trim Plate Replacement. 2. Remove the center console trim plate. Refer to Front Floor Console Side Trim Panel Replacement - Right Side. 	
1	Front Floor Console Compartment Filler (Qty: 2)
2	Front Floor Console Bolt (Qty: 1) Caution: Refer to Fastener Caution in the Preface section. Tighten 12 N·m (106 lb in)
3	Front Floor Console Nuts (Qty: 2) Tighten

	10 N·m (88 lb in)
4	Front Floor Console Assembly Tip Disconnect the electrical connectors.

© 2011 General Motors. All rights reserved.

Parking Brake Cable Adjuster Disabling

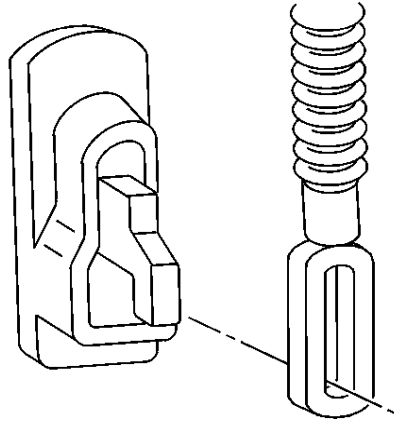

1. Raise and support the vehicle. Refer to [Lifting and Jacking the Vehicle](#) .
2. Remove the rear tire and wheel assembly. Refer to [Tire and Wheel Removal and Installation](#) .
3. Disconnect the park brake cable from the left and right park brake actuators.
4. Lower the vehicle.
5. Reposition carpet away from park brake lever.

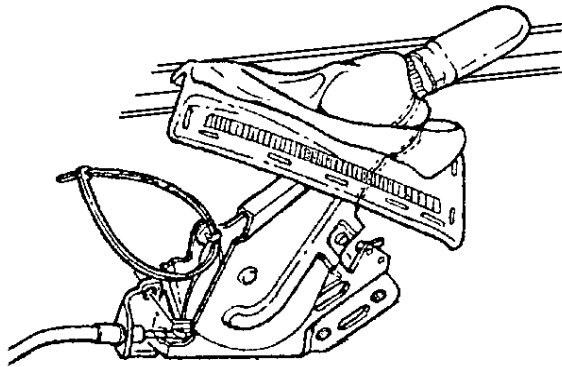

6. With the aid of an assistant, pull the disconnected park brake cable downward until it is fully extended and insert a rivet, drill bit or cotter key through the holes in the park brake lever mechanism as they line up. Do not overextend the cable.

Parking Brake Cable Adjuster Enabling

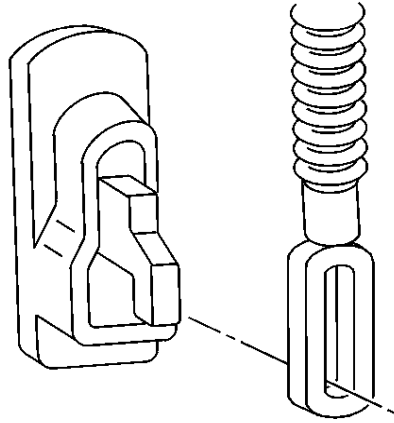

1. Raise and support the vehicle. Refer to [Lifting and Jacking the Vehicle](#) .
2. Remove the rear tire and wheel assembly. Refer to [Tire and Wheel Removal and Installation](#) .
3. Install the park brake cable to the left and right park brake actuators.
4. Install the rear tire and wheel assembly. Refer to [Tire and Wheel Removal and Installation](#) .
5. Lower the vehicle.

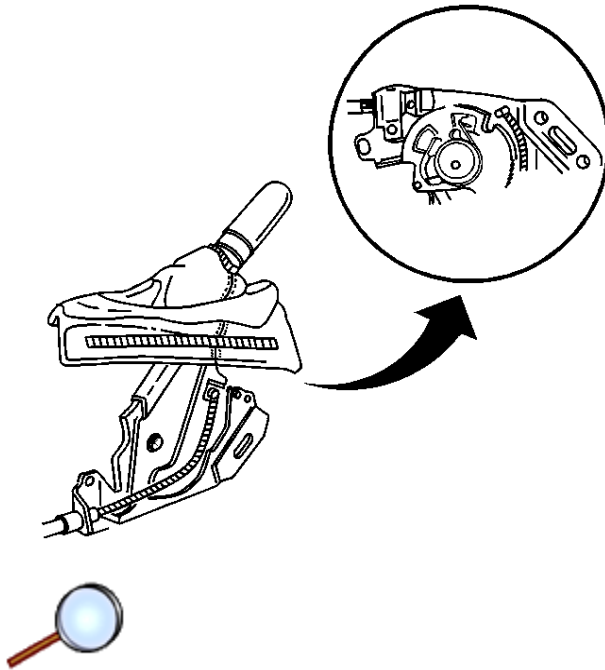

6. Reposition the carpet away from the parking brake lever.
7. Remove any rivet, drill bit or cotter key from the park brake lever.
8. Install the park brake cable to the park brake lever.
9. Install the carpet to its original position.
10. Cycle the park brake lever three times in order to obtain proper park brake cable tension.