

Steering Wheel Replacement

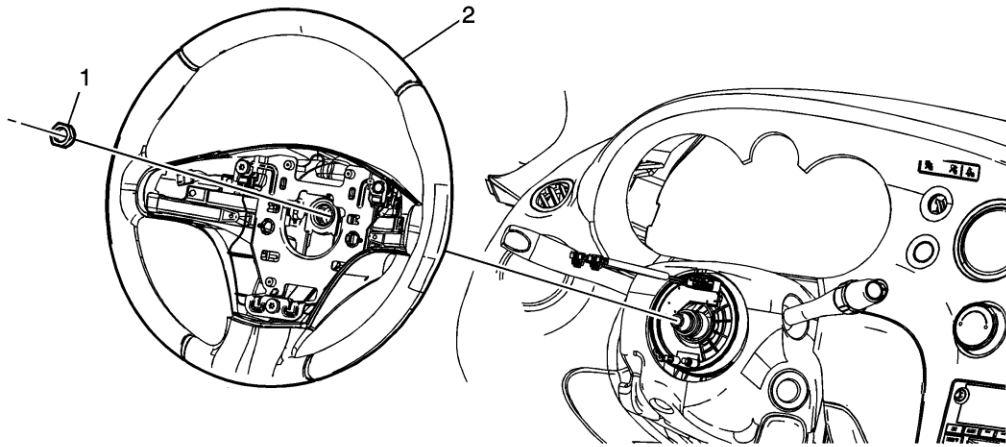

Callout	Component Name
<p>Preliminary Procedure</p> <p>Remove the inflatable restraint steering wheel module. Refer to Inflatable Restraint Steering Wheel Module Replacement</p>	
<p>1</p>	<p>Steering Wheel Nut</p> <p>Caution: Refer to Fastener Caution in the Preface section.</p> <p>Tighten 37 N·m (27 lb ft)</p>
<p>2</p>	<p>Steering Wheel</p> <p>Procedure</p> <ol style="list-style-type: none"> 1. Disconnect any electrical connectors as needed. 2. Use the <i>J 1859-A</i> puller and the <i>J 36541-A</i> puller legs to remove the steering wheel. <p>Special Tools</p> <ul style="list-style-type: none"> • <i>J 1859-A</i> Steering Wheel Puller • <i>J 36541-A</i> Steering Wheel Puller Legs <p>For equivalent regional tools, refer to Special Tools.</p>

Steering Wheel Inflatable Restraint Module Replacement

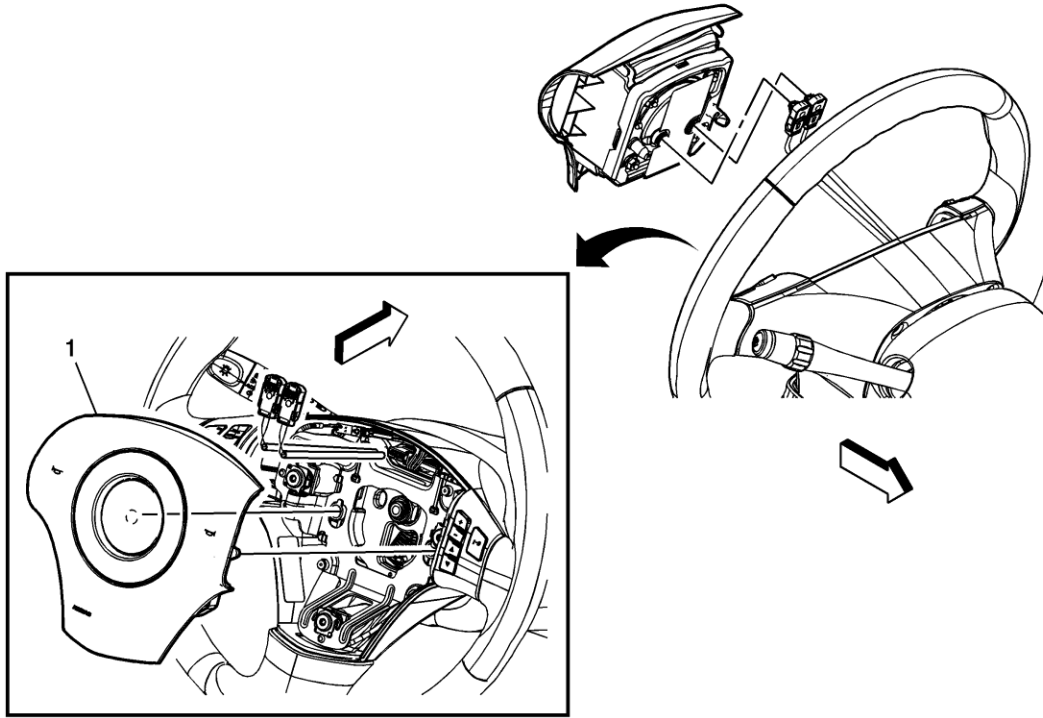

Callout	Component Name
<p>Warning: Refer to SIR Inflator Module Handling and Storage Warning in the Preface section.</p> <p>Warning: Refer to SIR Warning in the Preface section.</p> <p>Preliminary Procedures</p> <ol style="list-style-type: none"> 1. Disable the supplemental inflatable restraint (SIR) system. Refer to SIR Disabling and Enabling. 2. On the sides of the steering wheel are 2 circular openings, place the wheel so that one opening is on top. 3. Using a blunt-ended tool, push the spring fastener inward through the access hole. Repeat the step for the other opening. 	<p>Steering Wheel Inflatable Restraint Module</p>
<p>1</p>	<p>Procedure</p>

1. Release the connector position assurance (CPA) retainer.
2. Disconnect the electrical connectors.
3. Fully deploy the module before disposal. If the module was replaced under warranty, fully deploy and dispose of the module after the required retention period. Refer to [Inflator Module Handling and Scrapping](#).